

# TEMPORARY ROAD CLOSURE PROCEDURES

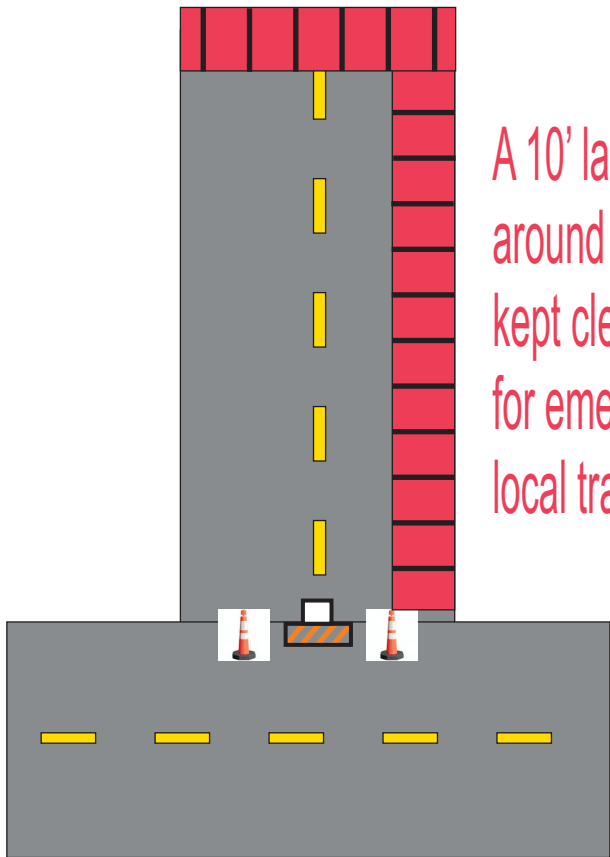

The following procedures shall be used when setting up a road closure for special events including residential block parties. Any questions should be directed to the Street Operations Dept. at 234-6194.

## Dead End or Cul-de-Sac Road



A 10' lane and turn around area must be kept clear to allow for emergency and local traffic access.



A road closed to thru traffic sign shall be placed in the center of the road, at the beginning of the block that is to be closed for the event.



Traffic cones shall be placed on each side of the road closed sign. Depending on the width of the road, 2-4 cones on each side shall be used. Cones shall be placed so as to allow local residents and emergency vehicles the ability to access the area.